

The following photos presented show that the restoration of Darren Lee's illegal mining activity is incomplete. We juxtaposed several of the photos with past pictures, to help create more context and visually show what the property looked like in the past.

We hope that this helps to address and combat the claims Darren Lee has made that he has fulfilled DOGAMI's suspension order requirement to flatten berms, fill test holes, match the previous contours of the land, and reseed the land.

I also included before and after photos of the new "road" that Darren has constructed. I know that DOGAMI is currently in a legal standoff with Darren Lee regarding this issue, so I hope the before photo helps to shed light on the fact that this "road" was never an actual road to begin with.

In addition to that, Darren Lee has done no work to restore the new work done in the old Quarry. There is photo evidence below to prove that.

Finally, I included photos and documented proof dating June 21st, 2023, that STRATA and Darren Lee were on the property, proving that samples were obtained and taken offsite, violating DOGAMI's suspension order.



Before:  
June 23rd, 2021



Now:  
January 2nd, 2024

This "road" has always been an overgrown ATV trail. We have lived up here for thirty years and have not once seen an automobile driving on this trail, until he began building it. In the same span of time, we've only ever seen ATVs a handful of times. From the before picture, you can clearly see that there was never a "road" there. Darren Lee, as stated in the Planning and Zoning meetings in 2021, said many times that he was going to turn this into a road in order to gain access for aggregate mining.

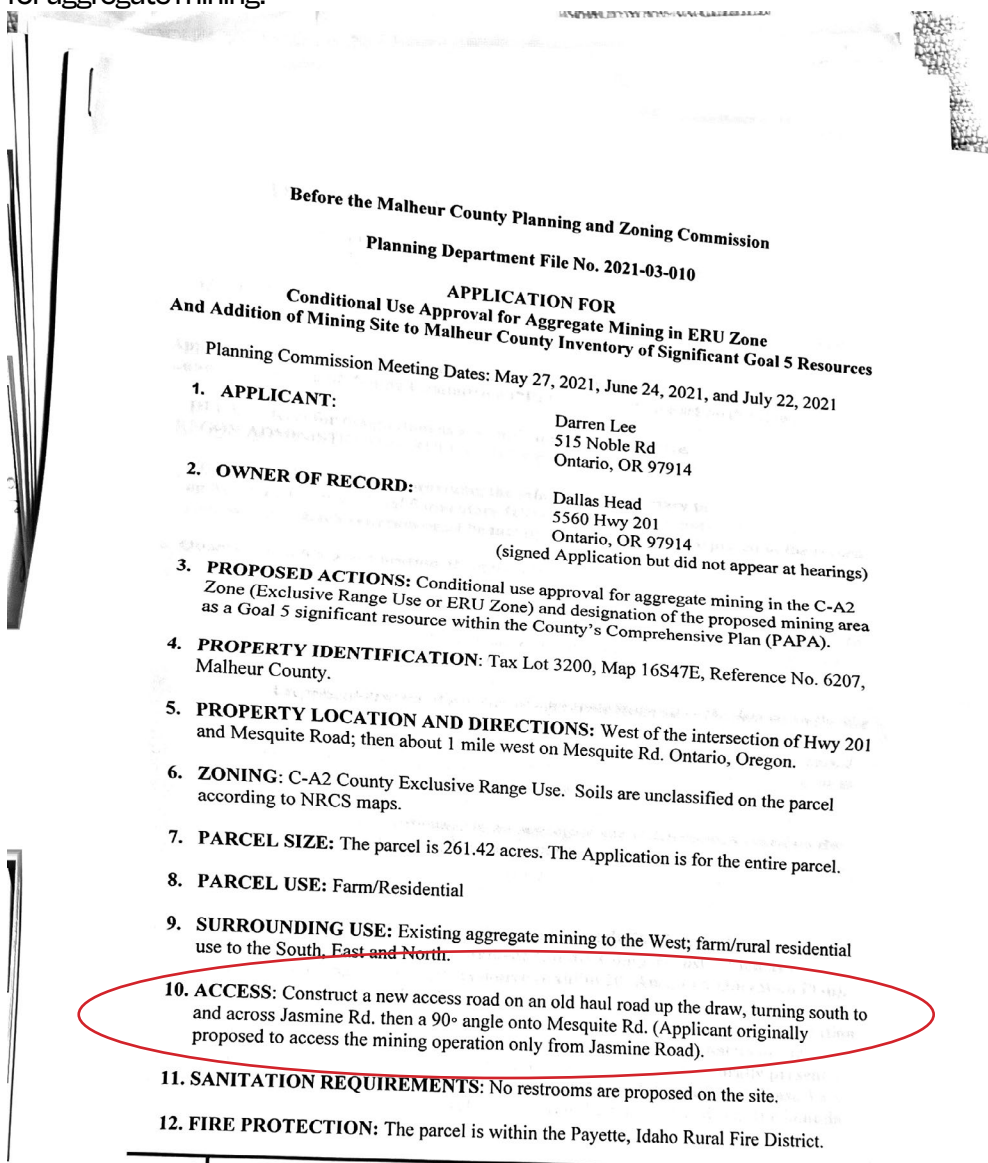



Before:  
February 18th, 2021



Now:  
January 2nd, 2024



Before:  
April 18th, 2018  
  
Fence line on left:  
Hastings property



Now:  
January 2nd, 2024  
  
Same fence line on left







Before:  
December 26th, 2017



Now:  
January 2nd, 2024





Before:  
December 26th, 2017



Now:  
January 2nd, 2024

The next few pages contain photo and documented evidence that proves that Darren Lee was mining illegally and that a third party, STRATA, removed material from the property and took it offsite on June 21st, while he was under his suspension order from DOGAMI. I present a letter from STRATA, the company who removed material for testing, which I procured from Darren Lee's newest application to Malheur County Planning and Zoning for Goal 5 status. I also included photos that were taken on the same day, showing STRATA removing material in white bags and Darren Lee at the site.



July 19, 2023  
File: B023051A

Mr. Darren Lee  
4 Lee's Excavation  
515 Noble Rd  
Ontario, OR 97914  
(208) 741-1104  
Clown924@hotmail.com

RE: **Gravel Quality Analysis**  
Dallas Head Quarry  
Malheur County, Oregon

Dear Mr. Lee:

STRATA is pleased to present the results of our Gravel Quality Analysis for the proposed expansion of the Dallas Head Quarry located near the intersection of Power Road and Jasmine Road in Malheur County, Oregon. This report has been developed in accordance with our proposal dated March 27, 2023. We received authorization to perform our services on June 14, 2023. The purpose of our services was to sample the gravel stockpiles from exploratory test pits that had been completed by others, and to perform laboratory suitability testing in accordance with Sections 8.8.1 and 8.8.2 of the 2023 *Oregon Department of Transportation (ODOT) Geotechnical Design Manual*.

#### PROJECT UNDERSTANDING

We understand that the owner of the area is seeking to develop Dallas Head Quarry which will include an approximately 80-acre area at the southeast corner of the intersection of Power Road and Jasmin Road in Malheur County, Oregon. The development area is located within the southwest and southeast quarters of the northwest quarter of Section 17, Township 16S, Range 47E of the Willamette Principal Meridian. Our understanding is that nearby areas have historically been used as aggregate sources. Prior to STRATA's involvement in this project, the owner excavated 5 test pits. The gravel from the test pits was stockpiled adjacent to the test pits. STRATA has been retained to sample the gravel stockpiles and perform laboratory testing in accordance with Sections 8.8.1 and 8.8.2 of the 2023 *Oregon Department of Transportation (ODOT) Geotechnical Design Manual*. We understand that the objective is to meet the Oregon Goal 5 standards for the new borrow source for Special Filter Material, Base Aggregate. The approximate location of the development area is shown on the Reference Map, included on the *Exploration Location Plan*, Plate 1.

#### GEOLOGY

The Geologic Map of the Oregon Part of the Baker 1° by 2° Quadrangle by Brooks, H.C., McIntyre, J.R., and Walker G.W. (1976) identifies rock in the area being comprised of ash-flow tuffs and tuffaceous sedimentary rocks. However, the soil observed in the on-site stockpiles and in the sidewalls of the previously excavated test pits appeared to contain alluvial gravel with silt, sand, and cobbles.

#### FIELD EXPLORATION

On June 21, 2023, we visited the project site and sampled from existing gravel stockpiles adjacent to the previously excavated 5 test pits throughout the project site. The test pit and sample locations are shown on the attached *Exploration Location Plan*, Plate 1. The stockpile material classified as gravel with silt, sand, and cobbles.

#### LABORATORY TESTING

Bulk samples for testing were gathered from each gravel stockpile adjacent to the test pit location. The bulk samples obtained from the site were combined into one composite sample, and all laboratory testing was performed on the combined sample.

STRATA performed laboratory testing on a composite sample to evaluate their engineering properties in accordance with *ODOT Geotechnical Design Manual* specifications. The laboratory testing included:



STRATA (white truck) and Darren Lee (brown and gold truck) at the site



STRATA truck with white bags full of material



STRATA and Darren Lee in his UTV, with same white bags of material in back



Darren Lee's truck on site

## Jasmine Rd

### Video Evidence

---

The link below leads to a youtube playlist that has video of the current state of Darren Lee's gravel pit and his attempted reclamation. We hope this helps give a good visual as to what it currently looks like.

[Click here to view videos.](#)